



Residential Plot for sale in Selwo, Estepona

610,000 €

Reference: R5077150 Plot Size: 1,128m² Build Size: 575m²



READY TO BUILD, YOUR DREAM AWAITS

Luxury Villa
575 sqm built
240 sqm terraces
Plot: 1,105 sqm
Buildability: 0,25
Occupation: 30%
Max height: GF+1 (7m)



Scan me for more info

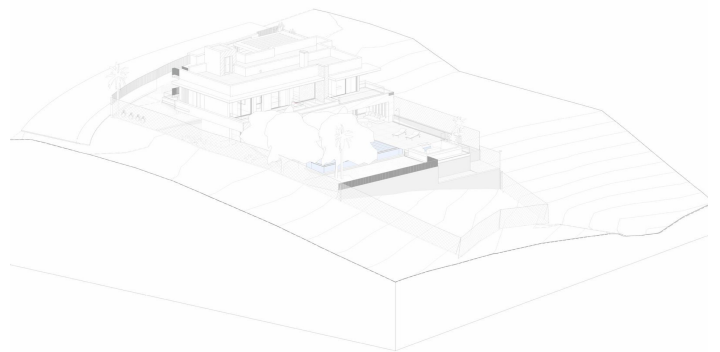



Costa del Sol, Selwo

Plot on the front line of La Resina Golf course, within the urbanization. Halfway between Marbella and Estepona, a perfect residential area to escape from the hustle and bustle, but having everything within a 10 minutes drive. Perfect to build a family villa. Investment opportunity for developers. Project ready to built with execution project in place for a luxury villa of 575 sqm built + 240sqm terraces. · Buildability 0,25 · Occupation 30%. · PB+1 (7m). · 3 PLOTS AVAILABLE. The villa has been meticulously designed to offer maximum comfort and style. With spacious open areas, high ceilings, and large windows, the homes are flooded with natural light, creating a cozy and sophisticated atmosphere. Modern kitchen, luxurious bathrooms, and high-quality details in every corner ensure that your home is a reflection of your success and good taste. Discover Luxury and Tranquility in the New Villas at La Resina Golf in Estepona Located in one of the most prestigious enclaves on the Costa del Sol, our exclusive luxury villas offer an unparalleled living experience next to the renowned La Resina Golf course in Estepona. This area is synonymous with elegance, comfort, and a superior quality of life, ideal for those seeking a home that combines luxury and serenity. Exceptional Environment The plot is set in a spectacular natural environment, surrounded by lush landscapes and panoramic views of the Mediterranean. The La Resina Golf course, known for its beauty and challenging design, offers residents the opportunity to enjoy this sport in a first-class setting. Additionally, the proximity to the vibrant city of Estepona provides access to a wide range of services, from gourmet restaurants and exclusive boutiques to international schools and high-end medical centers.



Features:

Orientation

South East

Views

Sea Views

Mountain

Panoramic

Garden

Golf Views

Setting

Urbanisation

Category

Investment

Resale

With Planning Permission